

WINDOWSILL INSULATING AND SEALING WEDGE

FDKtherm

*The thermal bridge-optimized interface
between building and construction element*



The window installation solution

Tested, applicable across all crafts, and sustainable

With the insulating and sealing wedge **FDKtherm**, as well as numerous additional components, you receive a multi-functional system for secure and time-saving installation of construction elements into a building – including a second water-bearing layer.



The **second water-bearing layer FDKtherm** is no longer visible after installation – but provides complete protection. A reveal panel pre-coated with a finishing plaster ensures a perfect transition into the facade surface and visually accommodates the windowsill edge in a rabbet.

FDKtherm

With our **insulating and sealing wedge** in combination with various lateral end caps and window frame-specific junction profiles, you receive a reliable windowsill substructure. Through gluing with our hybrid adhesive **vowafix one** you also receive a second water-bearing layer.

basic

P. 04

The flexible and economical solution for restoration and new construction! Perfect for window installation at the construction site or in the factory. Optimal for frequently changing window positions or window types and smaller quantities.

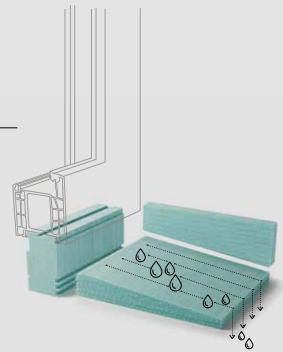

professional

P. 08

For the installation of batch production windows at the factory and consistently the same wall structures, we recommend the development of a customized, prefabricated system consisting of a windowsill junction profile as well as an insulating and sealing wedge to ensure an even faster and more seamless window installation.

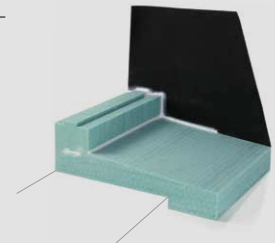

+ Reveal panel **LPtherm** P. 10

professional+

P. 12

Your contact for every type of building opening !

We take care of all interfaces between building and construction elements and deliver all components to you for reliable and fast installation of windows and doors.



individual

P. 15

Our products can be as individual as your building project.

With our raw materials and multiple processing options, we can create the construction element interface that is right for you.



TOBframe

P. 14

Completely prefabricated module - including window. Closure of building opening with only one construction element. The module **TOBframe** unites the clear definition of all interfaces with a high degree of variability, architectural sophistication, and cost effectiveness.



FDKtherm basic

The flexible and economical solution for restoration and new construction!

Perfect for window installation at the construction site as well as in the factory. Optimal for frequently changing window positions or window types and smaller quantities.

Advantages

- > In stock for all common window types
- > Can be modified with regular woodworking equipment
- > Available in small quantities
- > Standard delivery length: 2400 mm

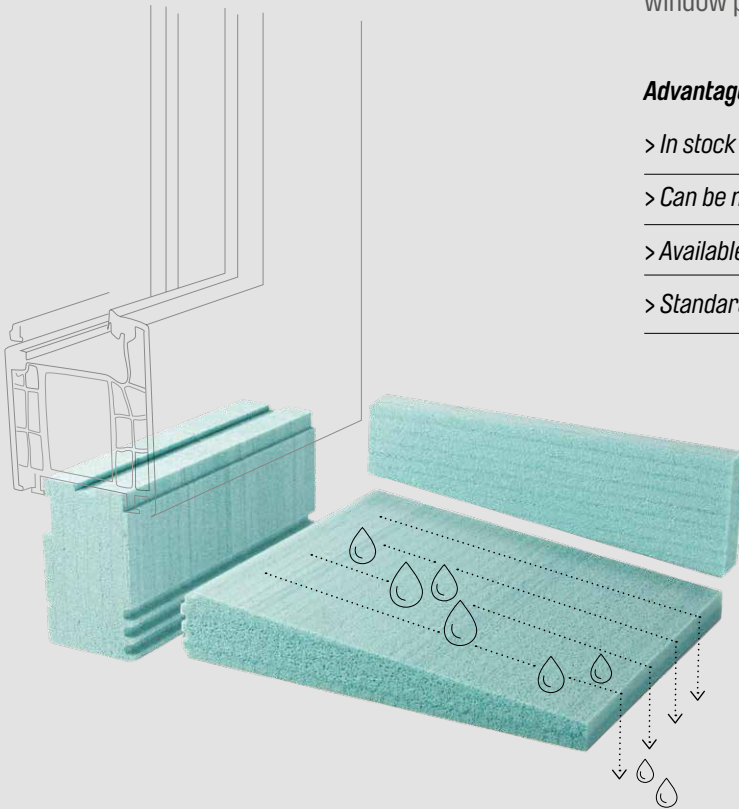

- > Impermeability to driving rain as per ift guideline MO-01/1
- > Climate cycles as per EOTA-ETAG 004

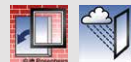

Wedge adapter with self-adhesive EPDM foil



EPDM corner with self-adhesive surfaces



Thermally-optimized **second water-bearing level**, also for standard window base junction profile

Possible combinations

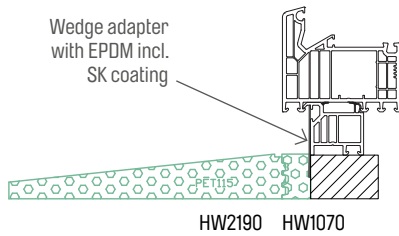

Synthetic window frame with PVC junction profile

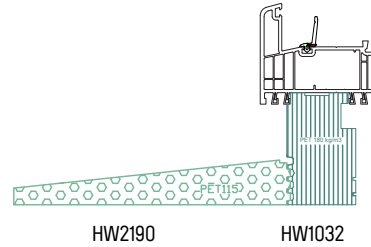

Synthetic window frame with PET junction profile

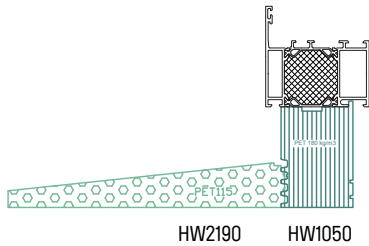

Aluminum window frame

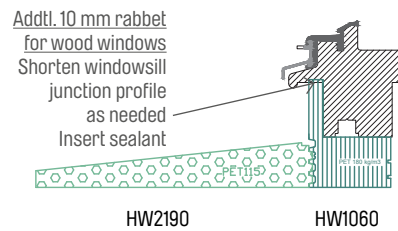

Wood window
Wood-aluminum window

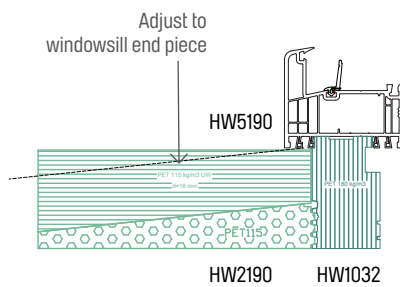

Lateral end cap PET

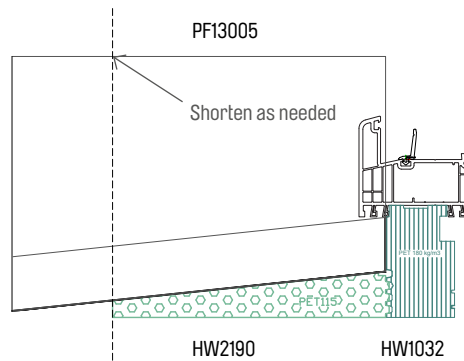

Lateral end cap EPDM

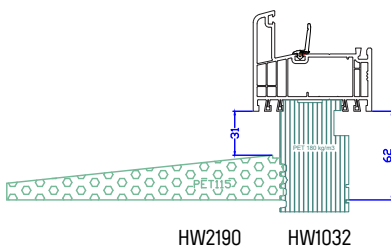

Wedge position for low edges e.g., Gutmann BF 406

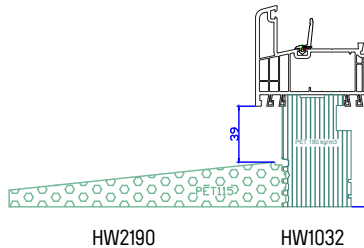

Wedge position for high edges e.g., Gutmann BF 4006

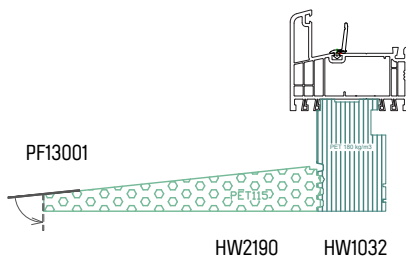

Wedge tip with EPDM-band for rear ventilated facades

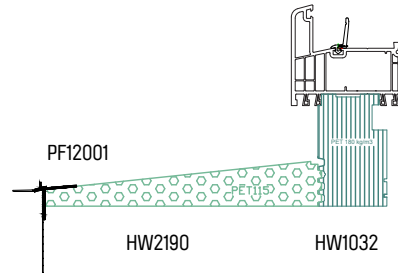





Wedge tip with drip edge profile for plaster facades

Base profiles

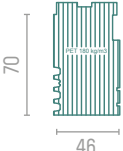
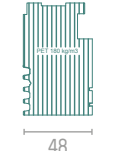
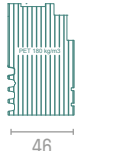
With the base profiles and corresponding accessories, every window installation situation can be solved easily and reliably.

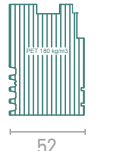
Windowsill Junction Profiles

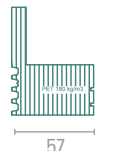
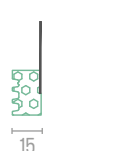
HW1031 U=0,84 W/m²K	HW1032 U=0,87 W/m²K	HW1033 U=0,84 W/m²K	HW1034 U=0,84 W/m²K	HW1037 U=0,84 W/m²K	HW1050 U=0,84 W/m²K	HW1060 U=0,84 W/m²K	HW1070
							
46	48	46	46	52	50	57	15
Profine 76 Profine 88	Gealan S8000 Gealan S9000	Aluplast Energeto Neo Aluplast Ideal 8000 Drutex Iglo Energy REHAU Artevo REHAU Geneo REHAU Synego Schüco Corona 70 Schüco Living 82	VEKA 76 VEKA 82 VEKA 90	Salamander 76 Salamander 82	Heroal W 72 Hueck WS 75 Schüco AWS 70 Schüco AWS 75 Wicona EVO 65 Wicona EVO 75	Wood frame Wood/aluminum standard profile	Window with standard profile

Lateral end caps PET, d=18 mm

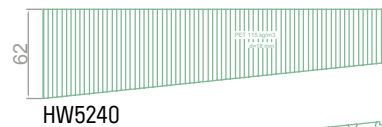

Windowsill insulating and sealing wedges

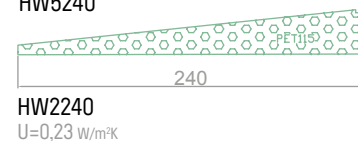
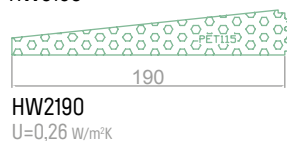

Can be combined with
reveal panels
LPtherm p.10



Drip edge profile
PF12001



EPDM-adhesive strip
PF13001



EPDM-sealing corner
PF13005



Accessories

Accessories for **FDKtherm basic** were developed and tested in cooperation with renowned manufacturers.

vowafix one Hybrid adhesive



Our system adhesive based on MS-polymers. It serves as adhesive and sealing material for the joining and sealing of **FDKtherm basic** components amongst each other as well as for the fastening of components in the reveal.

Drip edge profile GF



The drip edge profile with its reinforced mesh ensures proper junction of the wedge tip to the plaster facade.

EPDM-Strip



The junction of the tip of our insulating and sealing wedge to the facade membrane is realized through the EPDM-strip with SK-coating.

EPDM-corner



The protected EPDM-Corner with SK-coating on three sides ensures easy and fast sealing of the interface gap at the construction site and meets the requirements for window sealing as stipulated in the flat roof guideline.

FDKtherm professional

For windows in batch production at the factory and consistently the same wall structures (e.g., for manufacturers of prefabricated homes), we recommend the development of a customized, pre-manufactured complete system consisting of a windowsill junction profile as well as an insulating and sealing wedge to ensure an even faster and more seamless window installation.

Other advantages

- > Customized system solution
- > For batch production
- > Optional delivery on a commission basis
- > Significant reduction in manhours required for sealing and window installation

Dramatic increase in reliability with regard to airtightness and impermeability to driving rain. Tests of these systems with renowned manufacturers of ETIC systems showed positive results. The high product quality is further enhanced through the development and implementation of customized supply chain solutions.

In the development of a system solution, we assist you in the selection of optimal geometries and materials in reference to technical and economical requirements.

tested



Truly secure window installation:
FDKtherm as **second water-bearing layer**, combined with **LPtherm**



Sophisticated detail for the installation
of **stone windowsills**

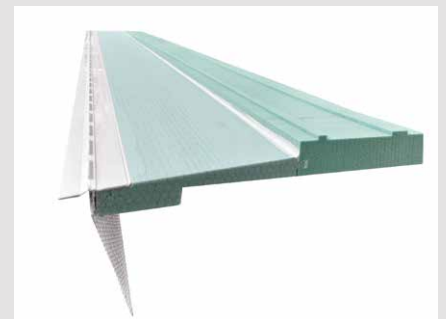

FDKtherm for **lift/sliding doors**

Applications

With **FDKtherm professional**, we plan the installation situations of other construction element types and locations in addition to the parapet windows. The goal is to develop the fewest components possible. This not only reduces storage costs, but also reduces complexity and thereby increases the reliability of the installation.

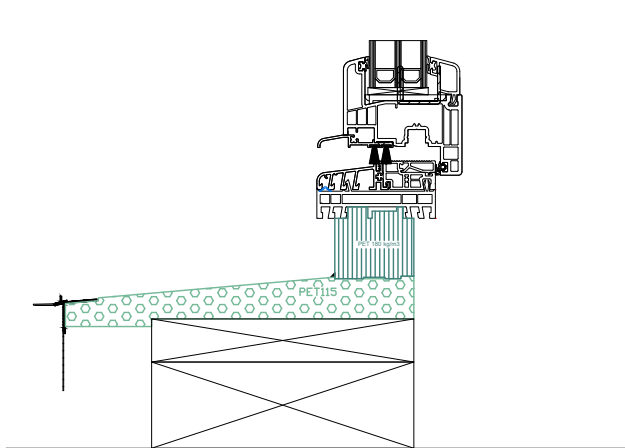

Secondary entrance door

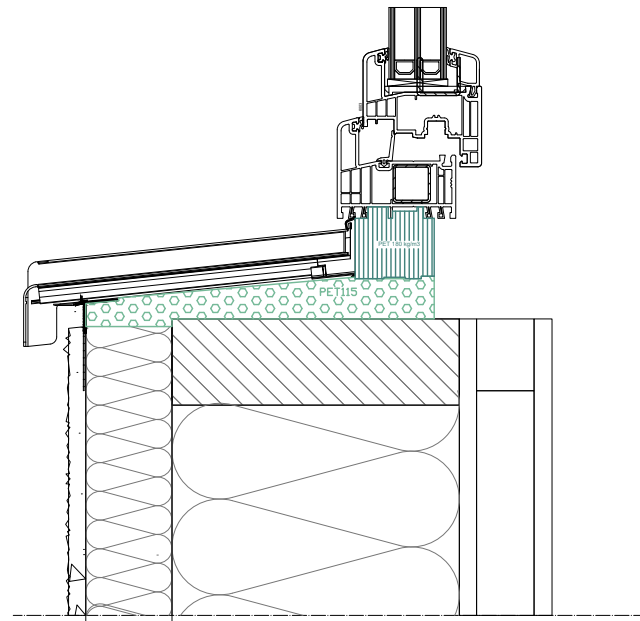

Parapet window

tested

- > Impermeability to driving rain as per ift guideline M0-01/1
- > Climate cycles as per EOTA-ETAG 004

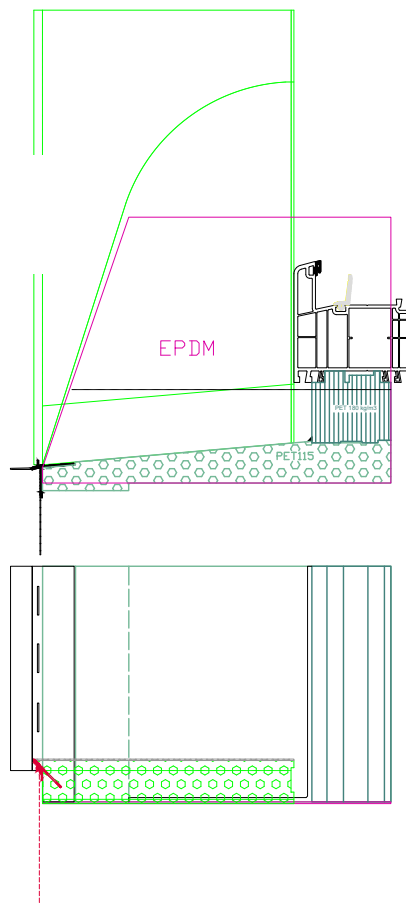

Delivery formats / Facade junctions

Delivery formats

Depending on quantity, **FDKtherm professional** can be delivered to the specific orifice width of the element or in individual components with left and right corner segments as well as a middle segment for insertion. **vowafix one** is used to glue the components to one another as well as in the reveal.

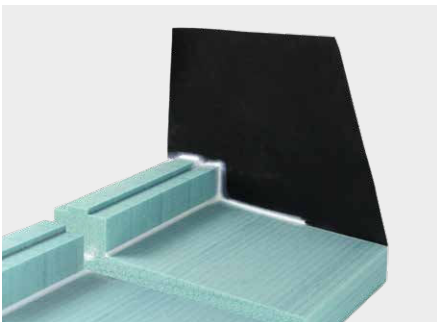

Left and right corner + middle segment



Bowl formation to fixed width

Facade junctions

Depending on the type of facade, the wedge tip and corner areas of **FDKtherm professional** can be configured with various components for the interface junction.



Wedge with **junction to plaster facade**
(drip edge profile)



Wedge with junction to **rear ventilated facade**
(EPDM outer corner)

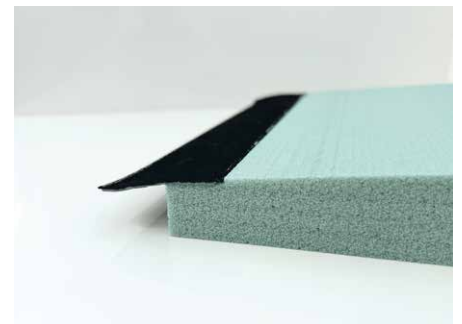

Wedge with junction to **rear ventilated facade**
(rabbet in wedge + adhesive strip)

REVEAL PANEL LP^{therm}

In addition to providing window frame insulation according to regulations, **LP^{therm}** reveal panels also save you time in installation due to their customized design specific to your individual installation situation.

Using various core materials, we produce reveal panels that feature, for example, integrated rabbets to cover windowsill edges, or integrated guide rails. Reveal panels are available unfinished, reinforced, or with a finishing coat.

Special features of LP^{therm}

- > Prefabricated in width, height, thickness and processing of ends.
- > Made from various core materials (XPS, PU, PET,...)
- > Optionally with
 - integrated guide rail
 - rabbet for windowsill edge
 - mesh bracket
- > Available in various coating systems
- > Frame insulation according to industry standards
- > Can be combined with FDK^{therm} insulating and sealing wedge

Standard Reveal Panels

Core: **PET^{therm} 50**

Coating: organically reinforced

Lengths: 1500 mm und 2500 mm

6 degree bevel cut on one side

30 x 190 mm: LP0190_PET

30 x 230 mm: LP0240_PET



- > Impermeability to driving rain as per ift guideline MO-01/1
- > Climate cycles as per EOTA-ETAG 004
- > Coating liability as per DIN EN 1015-12



Detail of lower junction point

FDKtherm professional+

Installation system

Your single-point-of-contact for all aspects of building openings !

We take care of all interfaces between building and construction element and deliver to you all components necessary for secure and fast installation of windows and doors.

You can select and combine the following:

- > *Insulating and sealing wedge*
- > *Reveal panel p. 10*
- > *Shading*
- > *Fall protection*
- > *Additional accessories*

All shading variations can be realized with one uniform window installation position. Boxes, guide rail systems, and windowsills can be revised anytime.



- > Impermeability to driving rain as per ift guideline M0-01/1
- > Climate cycles as per EOTA-ETAG 004

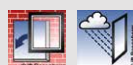

Shading: Variations

Multiple shading requirements can be solved with one installation position of the base box. In addition to the shading options, other functions such as insect or fall protection may be considered.

Roller shades

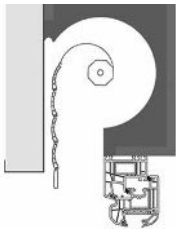

External blinds

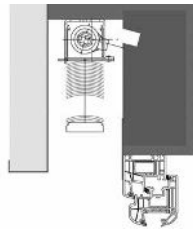

Fabric screen

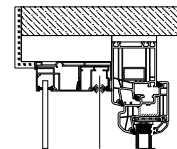
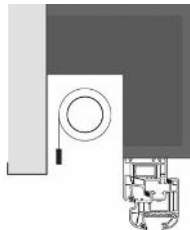

Additional
Insect protection

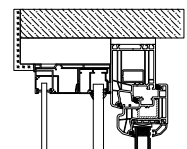

Additional
Fall protection

Shading: Options

Roller shades

- > Slats made of aluminum or synthetic material
- > Large selection of colors

External blinds

- > Slat sizes 60, 73, and 80
- > Painted with RAL paint or anodized

Fabric screen

- > Large fabric selection

Fall protection

- > Glass with U-channel profile
- > Size max. 3000 x 1200 mm
- > Integrated into guide rails

Drives

- > Motor, wireless, crank, strap
- > Can be combined with many SmartHome systems

Guide rails

- > Made from aluminum
- > Modular plug-in system
- > Painted with RAL paint or anodized

TOBframe

Complete system for batch window installation

The **TOBframe** module unites the clear definition of all interfaces with a high degree of variability, architectural sophistication, and cost effectiveness.

The module is delivered complete with a second water-bearing layer, reveal, shading, and construction element.

In addition to parapet windows, all other installation locations of a construction element – incl. necessary sealing requirements – can be implemented with **TOBframe**.

The closure and sealing of the building opening is completed with only one construction component.



Vertical cross section

- For plaster facades
- For double-skin facades such as wood, facade panels, etc.
- With second water-bearing layer **FDKtherm**
- With precoated reveal panels **LPtherm** or screwable reveal insulation

Windows in any frame material

Integrated shading with

- Roller shades
- External blinds
- Fall protection
- and much more

« just-in-time » installation in the factory or at the construction site

For wood and wood frame construction

Immediate construction protection
Stable construction schedule
Faster construction process

Horizontal cross section

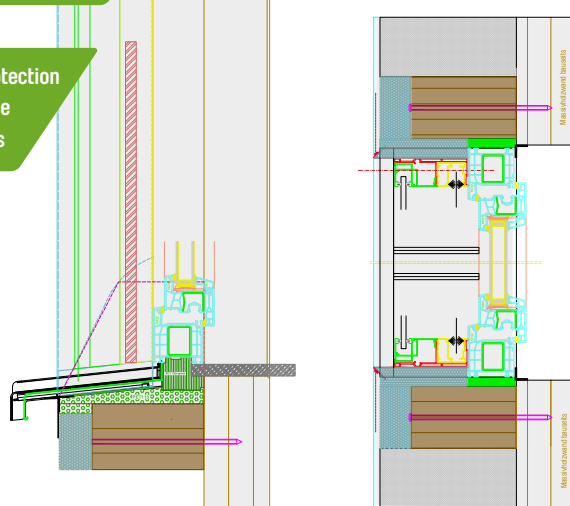

FDKtherm individual

Our products can be as individual as your construction project. With our raw materials and processing options, we can create the perfect construction element junction for you:

- > *any drainage angle*
- > *customized windowsill junction profiles*
- > *width to 500 mm*
- > *thin cross sections*
- > *lateral end caps for bowl formation*
- > *various accessories*

Contact us or send us your drawings and we will develop a proposal for you in short order.

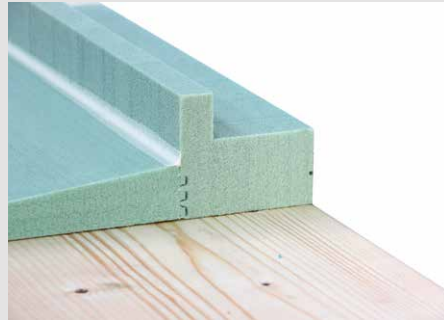

Windowsill junction profile for wood windows

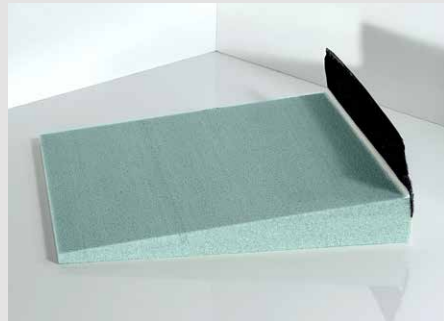

Wedge with EPDM-sealing foil

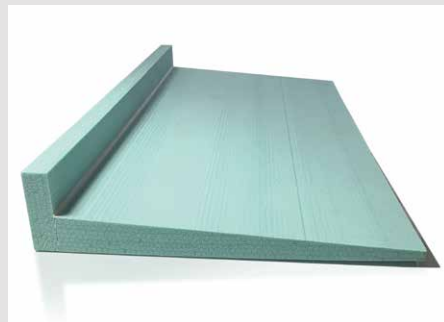

Protective profile for wood window with wedge extending to 500 mm

In addition to **FDKtherm**, we develop and produce other sustainable systems for thermal separation, construction, sealing, and insulation. Construction elements can be installed onto and into all building types in a timely manner and are designed to last long into the future. Our product palette includes the following:

basistherm
Windowsill junction profile

HSTtherm
Adapter profile for
lift/sliding door thresholds

vowa**therm**
Front wall installation system

UDPtherm
Substructure insulating profile

RVBtherm
Frame extensions

Our sustainable materials

KERDYN™ GREEN FR

The recycled and recyclable core material

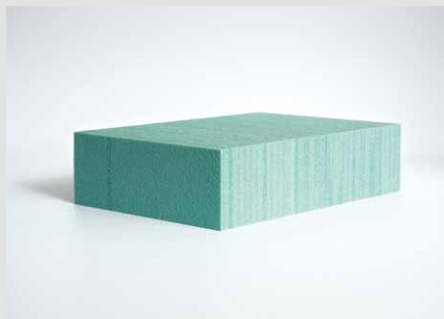

Kerdyn™ Green FR, as a PET-recyclate, is the new alternative to PUR construction materials. It provides lighter, more compact, and more efficient thermal separation and sealing. Due to its lower thermal conductivity, more efficient designs can be implemented with the same thermal bridge coefficient.

	Kerdyn™ Green FR 115	Kerdyn™ Green FR 180
Bulk density (kg/m³)	115	180
Compressive strength (N/mm²)	1,6	3,05
Thermal conductivity (W/mK)	0,0332	0,0403
Panel thickness	from 15 mm	from 4 mm
	up to 120 mm	
Panel format	1005 x 2440 mm / 1220 x 2440 mm	
Building material class	E (EN13501)	
Raw material	PET-recyclate	



PETtherm 50 THE GREEN INSULATING MATERIAL

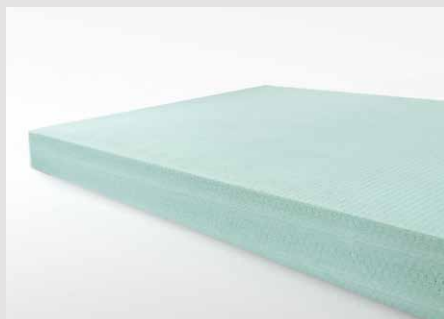

PETtherm 50, as a PET-recyclate, is the new alternative to PUR construction materials. It provides lighter, more compact, and more efficient thermal separation and sealing. Due to its lower thermal conductivity, more efficient designs can be implemented with the same thermal bridge coefficient.

	PETtherm 50
Bulk density (kg/m³)	48 +/- 10
Compressive strength (kPa)	> 150
Thermal conductivity (W/mK)	0,030
Panel thickness	20-200 mm
Panel format	1000/1220 x 2448 mm
Building material class	E (EN13501)
Raw material	PET-recyclate